

- Built-in Lifud flickering-free driver 220-240V AC, 50/60 Hz PF>0.95 (Tridonic, Osram optional)
- CREE COB 83Ra/95Ra (CITIZEN optional)
- For 2 wires, 3 wires, three-circuit track or surface mounting
- Rotation angle 350°
- Swivel angle 90°
- 0-10V, DALI, Triac dimming control system is possible
- Colors: Matt white/Matt black
- 5 years warranty
- Aluminum Housing



BST-TL-C

### Specification

Part NO	Power	LED Current	Luminous Flux	Light efficiency	Color rendering index	Color Temperature	Beam angle	Working temperature
BST-TL-10W-C	10W	250mA	900-1000lm	85-90lm/W	80-85Ra	2700-6500K	12° 24° 38° 60°	-25°C ~ +45°C
BST-TL-20W-C	20W	500 mA	1800-2000lm					
BST-TL-30W-C	30W	750 mA	2700-3000lm					
BST-TL-36W-C	35-37W	1000 mA	3150-3700lm					

CREE COB only can reach 5000K, if 6000K is requested, please choose CITIZEN COB. If need 40W, please choose CITIZEN COB.

The photometric values are standard values and refer to the entire luminaire.

In the case of CRI ≥ 90 the efficiency is approx. 10-15 % lower.

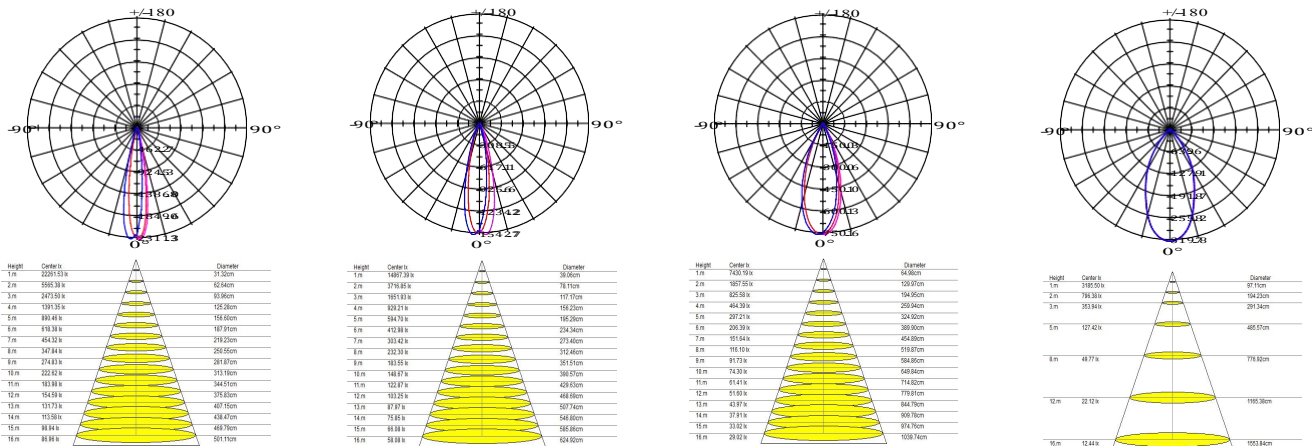

### Dimension

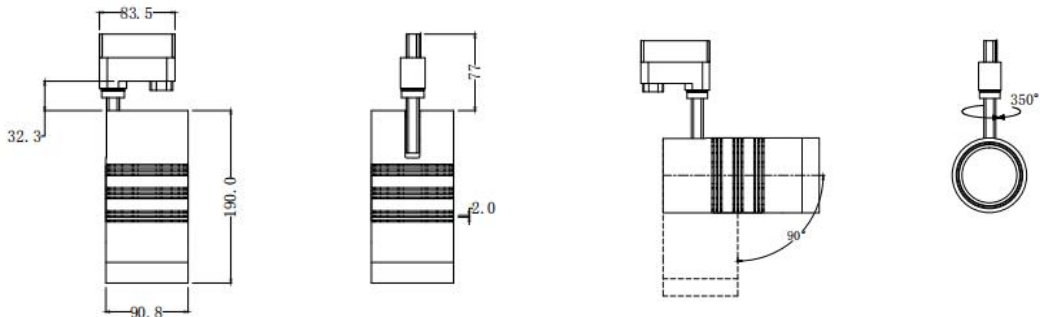

### Packing

10W-37W 10PCS/CTN  
12KG/CTN Carton size: 60\*31.2\*24.9cm